

**Lighting Requirements**

Per CBEES 150.0

- A. All installed luminaires shall be high-efficacy in accordance with Table 150.0-A
- B. All luminaires required to have light sources compliant with Reference Joint Appendix JA8, except hallways and closets over 70 sq. ft., shall be controlled by Dimmers or Vacancy sensors. Including all 6U-24 LED's and recessed luminaires.
- C. In bathrooms, garages, laundry rooms and utility rooms, at least one luminaire in each of these spaces shall be controlled by a Vacancy sensor.
- D. Outdoor Lighting: All outdoor lighting shall be controlled by a manual ON and Off switch that does not override to On and one of the following: Controlled by photocell and motion sensor, Photo control and automatic switch control, Astronomical time clock, or Energy management control system.
- E. Luminaires recessed into ceilings shall meet all of the following: Listed for zero clearance insulation, labelled that certifies the luminaire is airtight with a leakage less than 2.0CFM at 75 pascals, sealed with a gasket or caulk, allow replacement and maintenance to be readily accessible from below the ceiling without cutting holes in ceiling, shall not contain screw base sockets; and shall contain light sources that comply with JA8.
- F. Under cabinet lighting shall be switched separately than from other lighting systems.

Note CG2 -

At each dwelling unit, install a listed raceway to accommodate a dedicated 208/240-volt branch circuit. Raceway shall not be less than trade size 1 (nominal 1 inch inside diameter.) Raceway shall originate at the main service or subpanel and shall terminate into a listed cabinet, box or other enclosure in close proximity to the proposed location of an EV charger. Raceways are required to be continuous at enclosed, inaccessible or concealed areas and spaces. The service panel or subpanel shall provide capacity to install 40 ampere minimum dedicated branch circuit and space reserved to permit installation of a branch circuit overcurrent protective device.

Identification

The service panel or subpanel circuit directory shall identify the overcurrent protective device spaces reserved for future EV charging as "EV CAPABLE". The raceway termination location shall be permanently and visibly marked as "EV CAPABLE"

New construction shall comply with Sections 4.106.4.1 and 4.106.4.2 to facilitate future installation and use of EV chargers. Electric Vehicle Supply Equipment shall be installed in accordance with the Calif. Elect. Code, Article 625. 4.106.4

**Main Floor Plan**

1/4" = 1' 0" (3251 Sq. Ft. Living)

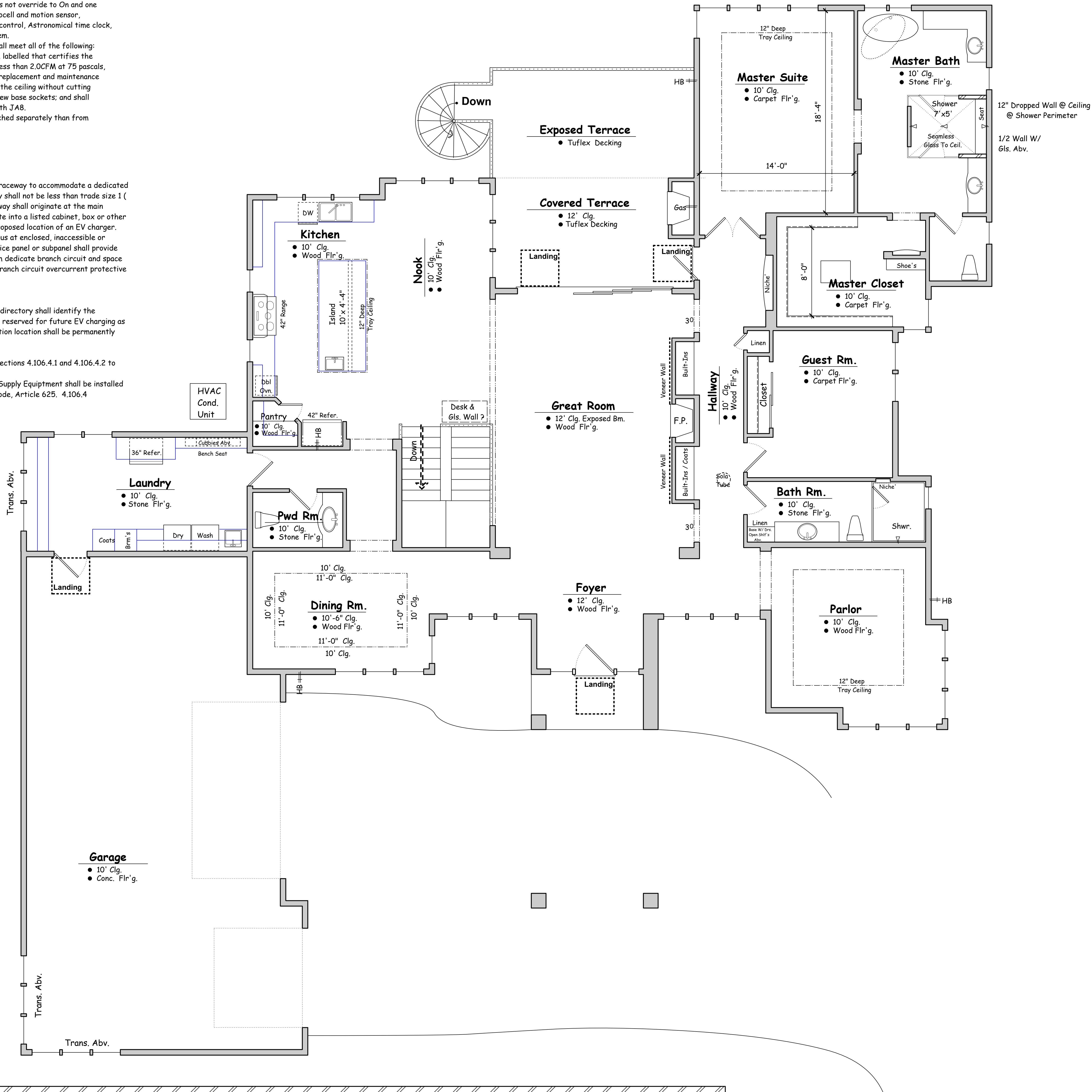
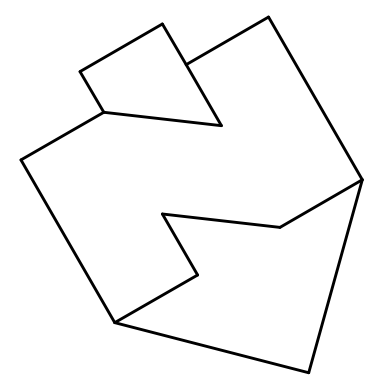

**Symbols Legend**

△ Telephone Jack	⊕ 110v Duplex Outlet (AFCI and Tamper Resistant)
⊠ Data Line Jack (computer)	⊕ 110v Duplex Outlet Dedicated (AFCI and Tamper Resistant)
◇ Television Jack	⊕ 110v Double Duplex Outlet (AFCI and Tamper Resistant)
○ 12 Station, Russ Sound	⊕ 110v Duplex Floor Outlet Field Verify Location (AFCI and Tamper Resistant)
▽ Alarm Station	⊕ 220v Outlet
⊕ Smoke Alarm	⊕ Ground Fault Interrupter
⊕ Thermostat	⊕ Weather Proof
⊕ Hvac Register	⊕ 1 Location Switch
RA Return Air Duct	⊕ 2 Location Switch
FAU Forced Air Unit	⊕ 3 Location Switch
⊕ Ceiling Fan	⊕ Switch W/ Dimmer
⊕ Ceiling Fan & Light	⊕ Vacancy Sensor Switch
⊕ Ventilator Fan (Separate Occupant Sensor Switch)	⊕ Humidity Sensor Switch
⊕ Ventilator Fan & Light (Separate Occupant Sensor Switch)	⊕ Sconce Fixture
⊕ Hose Bibb	⊕ Recessed LED Can Fixture
⊕ Gas Bibb	⊕ Recessed Mini-can Fixture
⊕ Tankless Water Heater	⊕ Wall Mount Fixture
⊕ Shower Head	⊕ Ceiling Mount Fixture
⊕ AFCI Arc-fault Circuit Interrupter	⊕ Recessed Fluorescent Can Fixture
⊕ S&P Shelf & Pole	⊕ Motion Sensor Fixture
⊕ CM Carbon Monoxide Alarm (Inter connected)	⊕ Fluorescent Fixture
⊕ Attic Exhaust Fan (Field Verify Location, See Roof Plan)	⊕ 2 Way Floor Fixture
⊕ WHF Whole House Fan (Field Verify Location)	⊕ Led Strips
	⊕ Led Fixture
	⊕ 4" Quartz Fixture

Symbol Indicates Min. 36"x36" Landing W/ Max. 7.75" Step Down If Door Does Not Swing Over Landing & 1.5" Step If Door Swings Over Landing. Landings Min. 2 Percent Slope Away From Foundation

1. The minimum ventilation rates shall be 50 cubic feet per minute for intermittent ventilation or 25 cubic feet per minute for continuous ventilation.
2. All smoke alarms shall be listed in accordance with UL217 and installed in accordance with the provisions of this code and the household fire warning equipment provisions of NFPA 72. Systems and components shall be California State Fire Marshal listed and approved in accordance with California Code of Regulations, Title 19, Div. 1 for the purpose for which they are installed.
3. All smoke alarm shall be interconnected with main power and battery back-up operations & audible in all sleeping areas.
4. The carbon monoxide alarms shall be listed as complying with the requirements of UL 2034. Carbon monoxide alarms and Carbox monoxide detectors shall be installed in accordance with this code, the current edition of NFPA 720 "Standard for the Installation of Carbon Monoxide Detection and Warning Equipment" and the manufactures installation instructions.
5. All carbon monoxide alarm shall be interconnected with main power and battery back-up operations.
6. Instant Gas Water Heaters to comply with CalGreen Code, and have a minimum efficient 0.79
7. All new 124 volt, 15 and 20 amp receptacles in dwelling unit shall be listed tamper resistant. CEC 406.12
8. Smoke detector near kitchen will be a photoelectric smoke alarm and not less than 10 feet from a permanently installed cooking appliance or located at least 20 feet from a permanently installed cooking appliance.
9. Outlet boxes or outlet box systems used as the sole support for ceiling (paddle) fans, Chandeliers shall be listed, shall be marked by their manufacturer as suitable for this purpose and shall not support ceiling-suspended (paddle) fans that weigh more than 32kg (70 lbs.)
10. All light fixtures in shower & tub areas shall be suitable for moisture locations.

**Whole House Ventilation**

EN2 Laundry room fan (Boran, Mdl # ZB80) continuous operating, on switch labeled to state: " Fan should be on whenever the home is occupied". The fan must be listed at 1 sone or less. See Manuf. specification sheet provided. Or may comply with CEC Manual specifications.

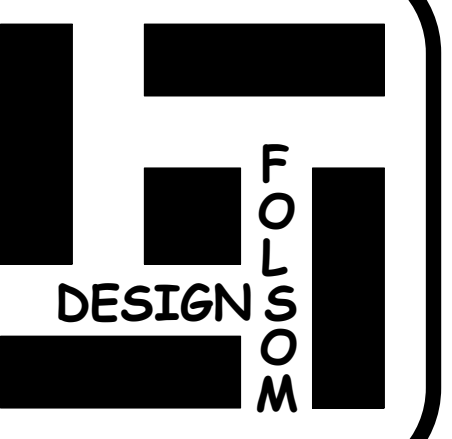

**Plan Preparation**

Folsom Designs  
301 Natoma St. # 105  
Folsom, Ca. 95630  
(916) 351-1400 Ph.

David Fischer

Signature Date 1-15-18

**Project Location**  
Lot 15, Empire Ranch Village 36B  
Lakeview Oaks Subd.  
Folsom, CA 95630

**A Residence by**  
Glenn Liebig  
273 Cimmaron Cir.  
Folsom, CA 95630

JOB #	515-06
DATE	1-15-18
SCALE	Noted
DRWN BY	DBF
APPR BY	
REVISIONS	DATE